

# POWERHOUSE™ HTD® TIMING PULLEYS

5 mm Pitch  
For 9 mm Wide Belts  
Hub and Flanges  
Aluminum  
Clear Anodized  
Finished Bore

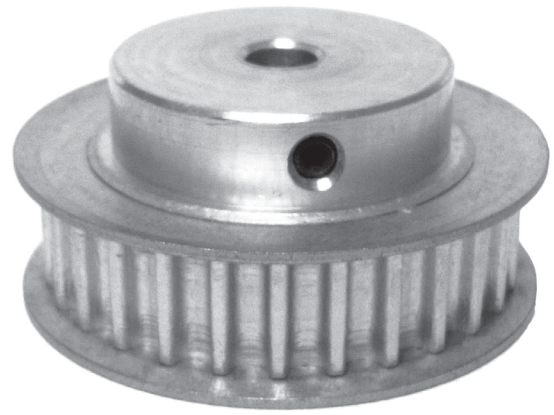

Part Number	No. of Teeth	Type	Pitch Dia. (in)	Out. Dia. (in)	Flange Dia. (in)	Bore (in)	Face	Overall Length (in)	Hub Dia. (in)	Set Screw
12-5M09-6FA3	12	6F	0.752	0.707	0.875	0.250	0.547	0.797	0.437	1 x 8-32
12-5M09-6FA4	12	6F	0.752	0.707	0.875	0.313	0.547	0.797	0.437	1 x 8-32
13-5M09-6FA3	13	6F	0.815	0.770	0.937	0.250	0.547	0.797	0.500	1 x 8-32
14-5M09-6FA3	14	6F	0.877	0.832	1.000	0.250	0.547	0.797	0.500	2 x 8-32 @ 90°
15-5M09-6FA3	15	6F	0.940	0.895	1.063	0.250	0.547	0.797	0.563	2 x 8-32 @ 90°
16-5M09-6FA3	16	6F	1.003	0.958	1.094	0.250	0.547	0.797	0.563	2 x 8-32 @ 90°
16-5M09-6FA4	16	6F	1.003	0.958	1.094	0.313	0.547	0.797	0.563	2 x 8-32 @ 90°
16-5M09-6FA5	16	6F	1.003	0.958	1.094	0.375	0.547	0.797	0.563	2 x 8-32 @ 90°
17-5M09-6FA3	17	6F	1.065	1.020	1.187	0.250	0.540	0.79	0.625	2 x 8-32 @ 90°
17-5M09-6FA6	17	6F	1.065	1.020	1.187	0.500	0.540	0.79	0.625	2 x 8-32 @ 90°
18-5M09-6FA3	18	6F	1.128	1.083	1.250	0.250	0.547	0.797	0.687	2 x 8-32 @ 90°
19-5M09-6FA3	19	6F	1.191	1.146	1.312	0.250	0.547	0.797	0.750	2 x 8-32 @ 90°
19-5M09-6FA6	19	6F	1.191	1.146	1.312	0.500	0.547	0.797	0.750	2 x 8-32 @ 90°
20-5M09-6FA3	20	6F	1.253	1.208	1.375	0.250	0.540	0.790	0.812	2 x 8-32 @ 90°
22-5M09-6FA3	22	6F	1.379	1.334	1.500	0.250	0.547	0.797	0.937	2 x 8-32 @ 90°
24-5M09-6FA3	24	6F	1.504	1.459	1.625	0.250	0.540	0.852	1.000	2 x 8-32 @ 90°
25-5M09-6FA3	25	6F	1.566	1.521	1.687	0.250	0.547	0.859	1.000	2 x 8-32 @ 90°
25-5M09-6FA4	25	6F	1.566	1.521	1.687	0.313	0.547	0.859	1.000	2 x 8-32 @ 90°
26-5M09-6FA3	26	6F	1.629	1.584	1.750	0.250	0.547	0.859	1.063	2 x 8-32 @ 90°
28-5M09-6FA3	28	6F	1.754	1.709	1.875	0.250	0.540	0.852	1.187	2 x 8-32 @ 90°
28-5M09-6FA6	28	6F	1.754	1.709	1.875	0.500	0.540	0.852	1.187	2 x 8-32 @ 90°
30-5M09-6FA3	30	6F	1.880	1.835	2.000	0.250	0.547	0.859	1.187	2 x 8-32 @ 90°
30-5M09-6FA4	30	6F	1.880	1.835	2.000	0.313	0.547	0.859	1.187	2 x 8-32 @ 90°
30-5M09-6FA5	30	6F	1.880	1.835	2.000	0.375	0.547	0.859	1.187	2 x 8-32 @ 90°
32-5M09-6FA3	32	6F	2.005	1.960	2.125	0.250	0.540	0.852	1.250	2 x 8-32 @ 90°
34-5M09-6FA3	34	6F	2.130	2.085	2.250	0.250	0.547	0.859	1.375	2 x 8-32 @ 90°

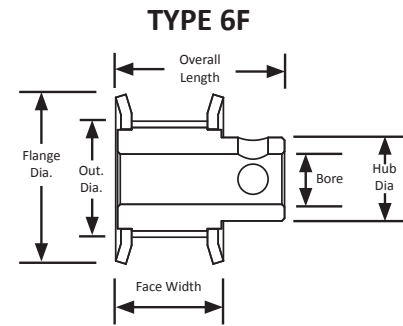

For Powerhouse™ ACHE sprockets,  
see page 174.



For idler pulleys,  
see page 366.